

## 146-K-54 - SPEEDLINE System Data Sheet - Version V1 (24-10-23)

SPEEDLINE 146mm 'C' Stud Partition @600mm  
Ctrs, with Knauf 15mm Soundshield Plus each side

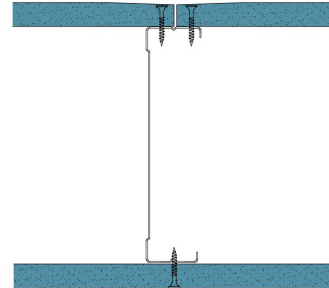

### System Performance Breakdown

Fire Resistance:

BS476 Part 22:1987:

Test Ref & Date or Applied Ref & Report:

Max Height:

Thickness:

Duty Grade: BS 5234: Part 2:1992:

Sound Insulation:

**60/60 Minutes** (Integrity/Insulation).

**BRE 285458 - BRE Report P102396-1011B**

**Refer to Speedline Specification Clause**

**178 mm.** (At Base Track, Excluding Finishes)

**Severe - Annexes A-F**

**42  $R_w$  dB**, Date Tested or Assessed Against - 70-K-53

Test Code:  
**H17446AA**  
Test Date:  
**28/06/2011**

Freq. Hz	R dB
50	23.5
63	13.2
80	10.1
100	20.8
125	15.1
160	27.4
200	28.4
250	33.8
315	35.7
400	40.6
500	43.3
630	47.7
800	52.3
1 000	55.6
1 250	58.0
1 600	60.2
2 000	57.4
2 500	44.5
3 150	40.1
4 000	43.3
5 000	48.0
6 300	
8 000	
10 000	

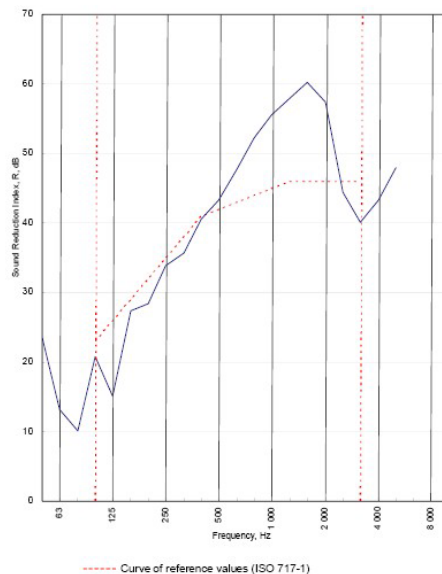

Rating according to  
BS EN ISO 717-1:1997  
Evaluation based on laboratory  
measurement results obtained by  
an engineering method:

**$R_w$  (C;Ctr) = 42 (-4;-9) dB**

Max dev. 10.9 dB at 125 Hz

$C_{50-500} = -5$  dB     $C_{50-1000} = -4$  dB     $C_{100-5000} = -3$  dB

$C_{1,500-1100} = -14$  dB     $C_{1,50-5000} = -14$  dB     $C_{1,100-5000} = -9$  dB

TESTED AT ONE OF THE UKAS  
ACCREDITED LABORATORIES  
BELOW

B.T.C  
(H-Ref on Graph)

B.R.E

AIRO

S.R.L



0444

Customer: **Metsec plc Hepsec Division**

BTC 17446A: Page 8 of 10



SPEEDLINE Drywall Systems, Adsetts House, 16 Europa View, Sheffield Business Park, Sheffield, S9 1XH.

Tel: 0114 231 8030.

Email: [enquiries@speedlinedrywall.co.uk](mailto:enquiries@speedlinedrywall.co.uk)

(As per the requirements set out in ISO/IEC 17025:2017 regarding test data the results stated have been carried out by voestalpine Metsec plc as part of the contract to supply Speedline Metal Sections to SIG Plc)